

# StarLite<sup>®</sup>

## Pop-Up Display Set-Up Instructions



Unpack expandable frame.

1



Open up frame as shown.

2

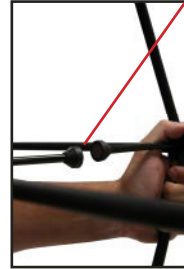
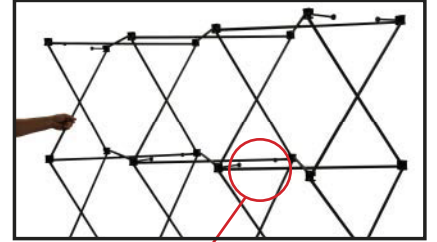

When frame is fully extended, magnetic joiners in middle snap together.

3



12 magnet bars are snapped into place on front of popup and 3 magnet bars will be snapped on each end of rear side.

4

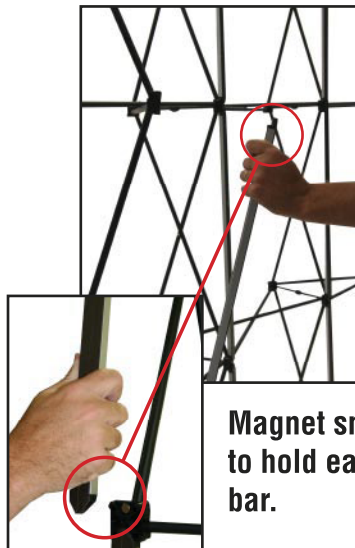

Magnet snaps to hold each bar.

5

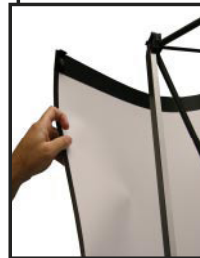
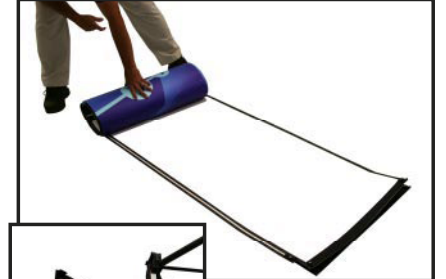

Unroll graphic panels, hang on magnet bars starting with end caps.

6

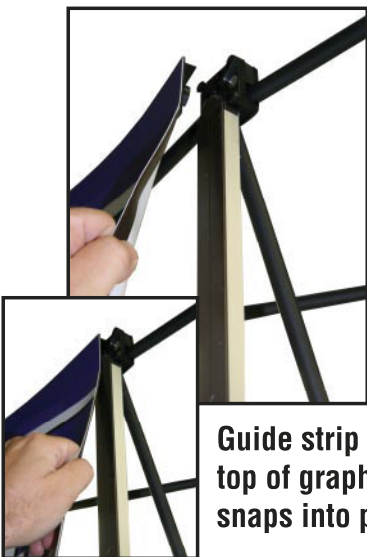

Guide strip on top of graphic snaps into place.

7

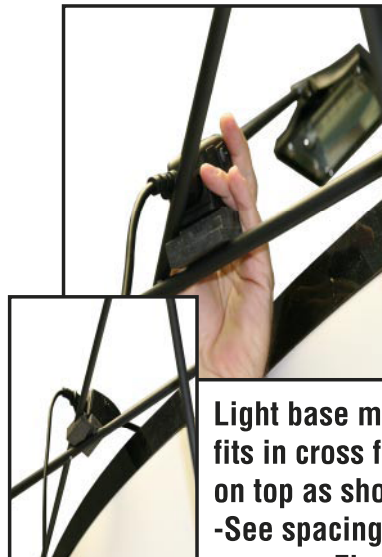

Light base mold fits in cross frame on top as shown. -See spacing in Fig. 9.

8



Unfold counter top and place as shown to make podium.

9