

## Product Care:

### General Product Care:

- \*Fabric should always be handled in a clean area with clean hands and equipment.
- \*Be sure fabric is clean and dry before packing.
- \*Machine washing and/or drying is not recommended for all fabrics or construction. Contact Moss with any questions.
- \*Roll fabric for storage. Fold inside out or face in along seams. Do not fold applied or silk-screened graphics. Pack in bag provided.
- \*Fabric may be ironed, on or off the frame. Use Permanent Press setting and non-waxed, non-inked paper between iron and fabric. Keep iron in constant motion.
- \*Always pack silk-screened and vinyl graphics with wax-free, ink-free paper or fabric shield to prevent its sticking to another surface.
- \*The aluminum frame in this product is susceptible to damage if improperly handled, shipped or stored. Use caution when handling and packing to prevent bending and/or crushing the tube.
- \*Pack in original shipping bags. Pack bags in corrugated cardboard box for shipping. Store product in a cool dry area (40-80F).

### Emergency Stain Treatment:

1. Prompt treatment of any stain is essential to successful treatment.
2. Identify the stain before you treat it. The guide below will assist you with treatment.
3. Use extreme care treating stains to avoid spreading the stain or creating more damage. Too much moisture can cause water stains or spread stain.
4. Treat the stain with fabric off the frame, if at all possible. Mark stained area with a box or tag using masking tape before removing for cleaning. This makes it easier to find the stain when the fabric comes off the frame. Stain removal will be more effective if you apply treatments from the side away from the stain (usually the inside face of the product). This is not possible with coated fabric and fabric constructions that have a liner (two layers of fabric). Stains on either of these must be treated from the stain side.
5. **TREATMENT:**
  - \*Lift scrape or blot as much of the staining material off as possible. (Blot with white cloth provided or similar. Avoid paper products)
  - \*Work from the outside edges toward the center of the stain.
  - \*Masking tape can be an effective lifting device for drier materials like loose dirt, pencil or ink.
  - \*For stains not responsive to water, follow the chart below and manufacturers instructions or call Moss Inc. for assistance.
  - \*Most natural stains may be treated with distilled water. Apply water to the back of the stain, and force water through fabric by pushing on the back while stretching the fabric. Or adding water while blotting, using care to keep the wet area as small as possible. Repeat procedure until water is running clear.
  - \*Rinse cleaner from fabric using distilled water, blotting from the outside of the stain towards center and dry thoroughly to avoid spreading the stain.

### STAIN

Blood  
Loose Dirt  
Fingernail Polish  
Ink  
Lipstick  
Oil, Grease  
Pencil  
Food/Drink

### Best Cleaner

Shout  
Stiff Brush  
Denatured Alcohol  
Tape/Denatured Alcohol  
Shout  
K2r  
Tape/Denatured Alcohol  
Shout

### Alternative Solution

AMODEX, 3% Hydrogen Peroxide  
Shout, Pre-Spot  
ACETONE  
AMODEX  
AMODEX  
Corn Starch & Shout  
AMODEX, Pre-spot  
Contact Moss

**NOTE:** This information is provided to assist you with the care and maintenance of your Moss Product. No expressed or implied warranty is intended. Please contact Moss for details or assistance.



### Common Troubles

- Fabric Cover Not Fit** - Assure all 4 corners of cover are positioned over frame corners before starting to zip cover closed.
- Hard to adjust cover** - Cover position on frame is easily adjusted when cover is NOT ZIPPED. It is easiest to adjust cover by pulling on un-zipped sides of fabric.
- Frame miss-shaped** - Make sure connectors are very tight. Frame warp can be easily corrected by laying structure flat face down on the floor and lifting upright from both sides.
- Wrinkles in cover** - Use a hand steamer to remove small wrinkles. Adjust cover position for large wrinkles.



Vertical Curve Back Wall  
Available sizes: 8x10, 8x8

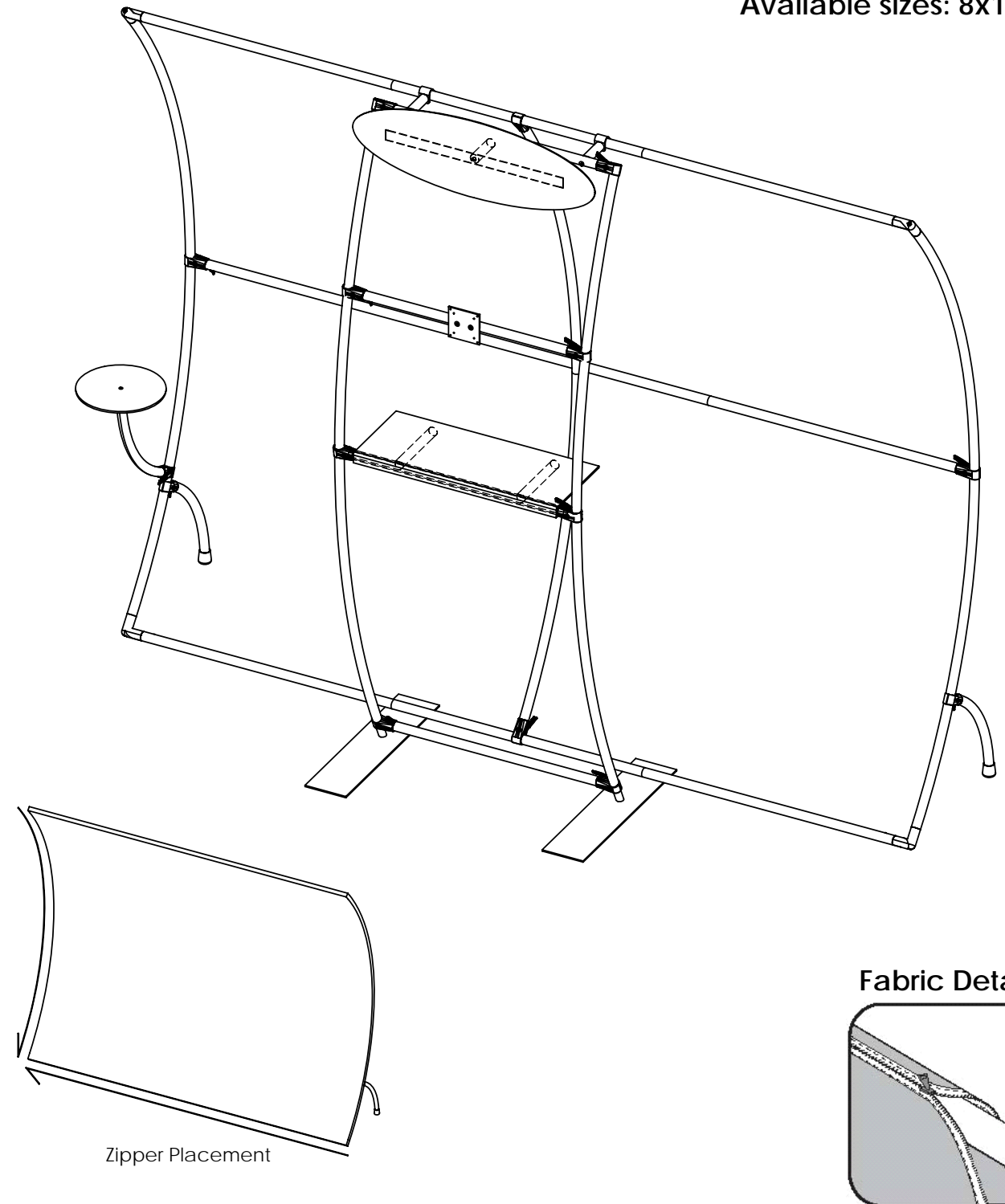

### Fabric Detail

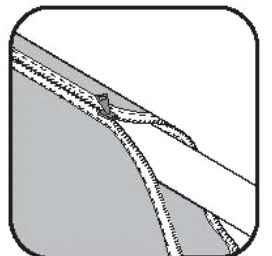

Assembly Instructions:  
See Inside  
11/6/08

### General Instructions:

- \*Read and follow all instructions.
- \*Save instructions.
- \*Wipe down all tubing, clean work area and lay out plastic sheeting.
- \*Repack fabric carefully and neatly in the original fabric bag provided.
- \*Repeat packing instructions for frame.

### Workmanship Guarantee:

Moss Inc. Fully guarantees all exhibits against defects in workmanship. If our products receive proper care, but fail due to a defect in manufacturing, the exhibit will be repaired or replaced at our discretion. Damage to exhibit products caused by accidents, improper care or negligence, where Moss Inc. is not at fault (including sun degradation and wear and tear) repairs will be performed for a reasonable fee.

**WARNING:** Hanging system and structure are designed for:  
(1) indoor use only and (2) to hold the weight of the structure and fabric cover only. No other loads should be applied to this display system.



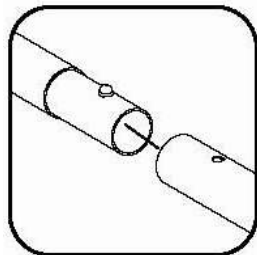

Snap Pin Detail

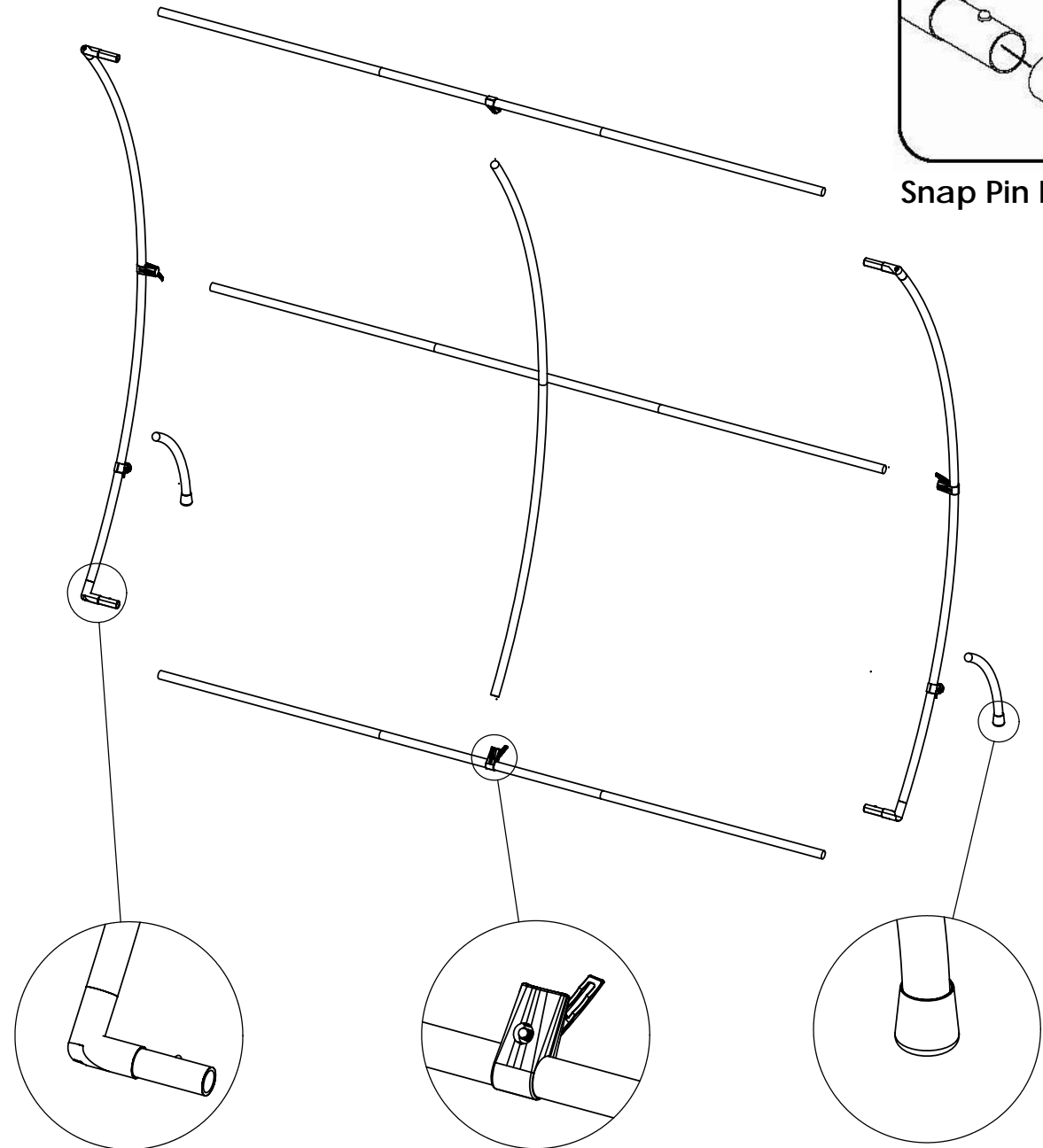

Corner attached to side bars  
(DO NOT TAKE APART)

Quick Lock Connector Detail  
To clamp & adjust, simply tighten  
or loosen lever on the clamp to achieve  
desired strength.  
Connector is attached to outside bars!

Adjustable foot  
Detail

**Set Up Instructions for a Vertical Curve Back Wall:**

- (1) Snap fit all shock corded bars together to create individual bars as shown.
- (2) Build frame lying down on floor. This will ensure accuracy.
- (3) Snap corners into straight bars as shown.
- (4) Attach curved spacer & straight spacer as shown by using quick lock connectors provided. Place connector over seams on vertical curved bars.
- (5) Connectors for curved spacer should be placed in the center of top & bottom straight bars as shown.
- (6) Secure feet to side curved bars through holes provided in back of fabric cover. Adjust foot as needed for stability.

**Stand off & Accessory options:**

Curved Stand off  
(36" & 18" wide)

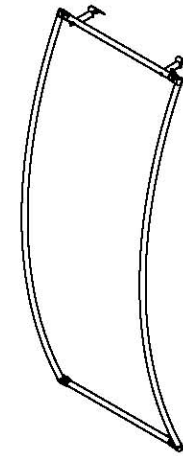

Straight Stand off  
(36" & 18" wide)



Shelf Package  
#3555-36" straight / #3557-36" curved  
#3556-18" straight / #3558 18" curved

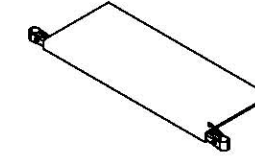

Header Bracket  
#3640

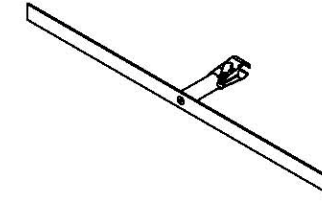

Grid Wall Fixture  
#3628-36" wide

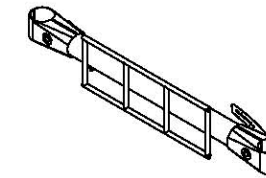

Stabilizing Feet (Straight Stand off)  
#3584 - short feet straight  
#3583 - long feet straight

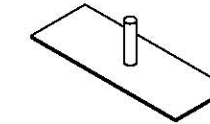

Horiz. Monitor Bracket  
#3608-36"

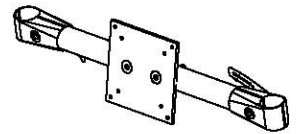

Vertical Monitor Bracket  
#3605-18", #3606-36"

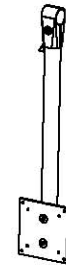

Shoe Toe Hold  
#3625-7"x10"

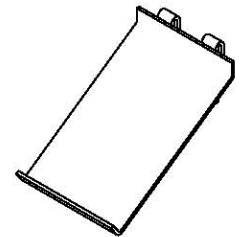

Stabilizing Feet (Curved Stand off)  
#3582 - short feet curved  
#3581 - long feet curved

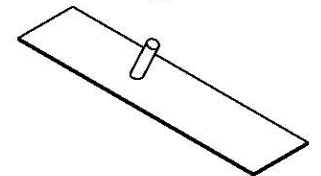

**Back Wall Accessory options:**

#3565 Table top:

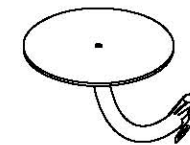

#3566 - Liter. holder.  
(must purchase side table as well)

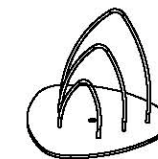

Frame Light Models:  
#3610 - STD  
#3611 - Deluxe

